



# DynaPen Series from Dynabrade



Reciprocating Tool for Engraving and Precision Deburring



- Accepts Scribe Points, Files and Chisels for Countless Applications
- Rapid Reciprocating Action and Short Stroke Length
- Offered in Several Application-Focused Kits



# Dynabrade DynaPen Series

*DynaPen accepts multiple accessories for engraving, precision removal and deburring. Combining rapid action with short stroke length, DynaPen is used on plastics, composites, steel, aluminum and more. An essential tool for industries such as aerospace, mold-making, firearms, machine and model shops, plus computer and cell phone manufacturing!*

## Model 10843 1/8" Collet Insert (51659) Model 10832 3 mm Collet Insert (51673)

- Lightweight pneumatic tool operates at 14,000 strokes per minute, providing fast, efficient material removal.
- Short stroke length of .007" (.018 mm) minimizes risk of gouging delicate surfaces.
- 1/8" and 3 mm Collet Inserts accept Scribe Points, Files and Chisels. Optional Collet Inserts of 1/16" (51780) and 3/32" (51674) also available.
- In-line filter prevents debris from entering tool through air line, ensuring longer tool life.
- "Easy Grip" rubber sleeve ensures comfortable and secure tool handling.
- Air line swivels 360° for greater maneuverability, especially on contoured parts.
- 95731 Wrench (included) allows quick one-step change of all accessories.

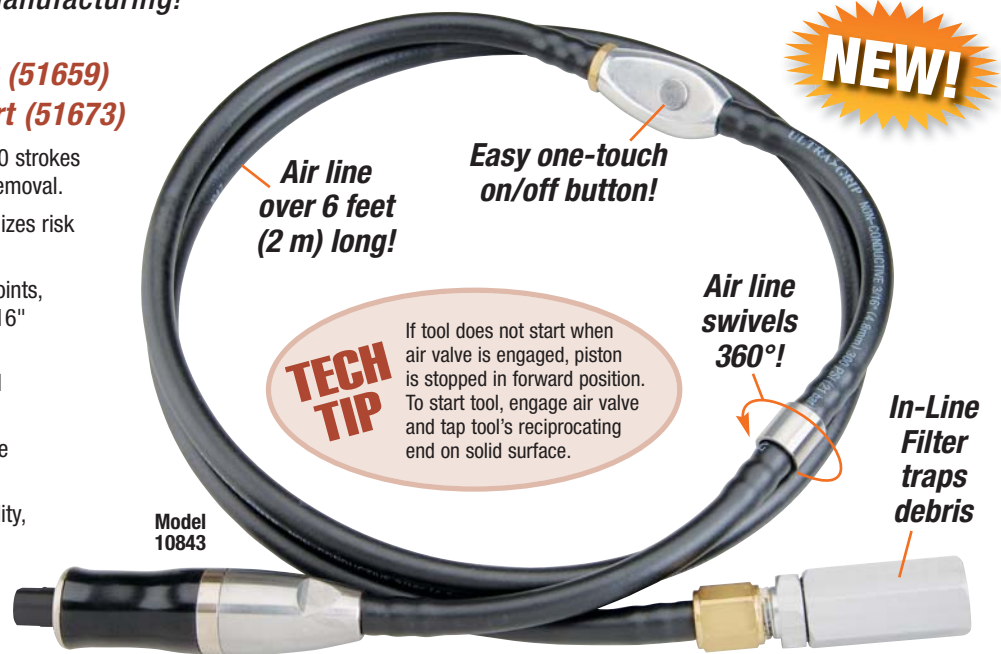

Model Number	Motor SPM	Stroke Length Inch (mm)	Maximum Air Flow SCFM (LPM)	Air Pressure PSIG (Bar)	Collet Size	Weight Pound (kg)	Length Inch (mm)	Diameter Inch (mm)	Hose Length Inch (mm)
10843	14,000	.007 (.018)	7 (28)	90 (6.2)	1/8"	.57 (0.26)	4.25 (108)	.9 (23)	56 (142)
10832	14,000	.007 (.018)	7 (28)	90 (6.2)	3 mm	.57 (0.26)	4.25 (108)	.9 (23)	56 (142)

## DynaPen Filer Kit

*Includes Assortment of Popular Files!*

- DynaPen with File is ideal for intricate deburring and finishing on delicate parts.
- Accepts Reciprocating Files 3-1/2" (89 mm) long, in various shapes. Three files included in Kit.



### 10844 Kit

- 10832 DynaPen with 51673 Collet Insert (3 mm)
- 51659 Collet Insert (1/8")
- Swiss Pattern Files: 90900 Equaling, 90901 Curved, 90930 Half-Round
- 95731 Wrench



**TECH TIP**

When operating DynaPen with Swiss Pattern File, move tool forward on work surface. This results in faster rate of removal.



# DynaPen Scribe Kit

*Includes Scribe Point for Engraving!*

- DynaPen with Scribe Point easily engraves metal, wood, stone, glass and composites.
- Ideal for use in aerospace accounts and maintenance departments, where parts are engraved for identification and tracking.
- Scribe Point made of high-carbon steel, heat-treated and tempered to hardness of 62 Rockwell.



## 10846 Kit

- 10843 DynaPen with 51659 Collet Insert (1/8")
- 90990 Scribe Point (1/8") – High-Carbon Steel
- 95731 Wrench

## 10847 Kit

- 10832 DynaPen with 51673 Collet Insert (3 mm)
- 90991 Scribe Point (3 mm) – High-Carbon Steel
- 95731 Wrench

*See Page 4 for DynaPen Kit with ALL Accessories!*



# DynaPen Chisel Kit

*Includes Narrow and Wide Chisels!*

- DynaPen with Chisel is effective for removing parting lines on metal and plastic.
- An important tool for dental mold-makers, jewelers, artists and in archeology shops.



## 10848 Kit

- 10843 DynaPen with 51659 Collet Insert (1/8")
- 90992 Chisel (1/8") with 1/8" wide tip
- 90994 Chisel (1/8") with 1/4" wide tip
- 90990 Scribe Point (1/8") – High-Carbon Steel
- 95731 Wrench

## 10849 Kit

- 10832 DynaPen with 51673 Collet Insert (3 mm)
- 90993 Chisel (3 mm) with 3 mm wide tip
- 90995 Chisel (3 mm) with 6 mm wide tip
- 90991 Scribe Point (3 mm) – High-Carbon Steel
- 95731 Wrench



**TECH TIP**

When operating DynaPen with Chisel, hold tool at angle shown. This helps prevent "scooping" or "gouging" of work surface.

# DynaPen Kit

*Includes Files, Scribe Point and Chisels. The Ultimate in Versatility!*

**NEW!**

## 10850 Kit

- 10843 DynaPen with 51659 Collet Insert (1/8")
- Swiss Pattern Files: 90900 Equaling, 90901 Curved, 90930 Half-Round
- 90990 Scribe Point (1/8") – High Carbon Steel
- 90992 Chisel (1/8") with 1/8" wide tip
- 90994 Chisel (1/8") with 1/4" wide tip
- 95731 Wrench

## 10851 Kit

- 10832 DynaPen with 51673 Collet Insert (3 mm)
- Swiss Pattern Files: 90900 Equaling, 90901 Curved, 90930 Half-Round
- 90991 Scribe Point (3 mm) – High Carbon Steel
- 90993 Chisel (3 mm) with 3 mm wide tip
- 90995 Chisel (3 mm) with 6 mm wide tip
- 95731 Wrench



**TECH TIP**

Lubrication of DynaPen is not necessary during operation. For tool storage, add one drop of oil after use, then run tool for five seconds. Tool is now lubricated for storage.

Model Number	Base Model	Collet Insert	Equaling File	Curved File	Half-Round File	Scribe Point	Narrow Chisel	Wide Chisel	Wrench
10850	10843	1/8" (51659)	90900	90901	90930	90990	90992	90994	95731
10851	10832	3 mm (51673)	90900	90901	90930	90991	90993	90995	95731

## Swiss Pattern Files *(sold separately)*

### Straight Files; 3-1/2" - 4" Lengths; 1/8" Dia. Shank

File/Cut	Equaling	Three-Square	Half-Square	Half-Round	Crochet	Round
Straight File Medium Cut 1	90900	90910	90920	90930	90940	90950

### Curved Files; 3-1/2" - 4" Lengths; 1/8" Dia. Shank

File/Cut	Equaling	Three-Square	Half-Square	Half-Round	Crochet	Round
Curved File Fine Cut 2	90901	90911	90921	90931	90941	90951

***DynaPen Scribe Points and Chisels Also Available Separately!***

***Discover The Dynabrade Difference!***



Visit our Website for more Tools and Related Accessories  
**www.dynabrade.com**

### **DYNABRADE, INC. • DYNABRADE INTERNATIONAL**

8989 Sheridan Drive • Clarence, New York 14031-1419  
Phone: (716) 631-0100 • US Fax: 716-631-2073 • Int'l Fax: 716-631-2524  
**US Consumers Call Toll-Free: 1-800-828-7333**  
**Canadian Consumers Call Toll-Free: 1-800-344-1488**

### **DYNABRADE EUROPE S.à r.l.**

Zone Artisanale Op Tomm 6 • L-5485 Wormeldange—Haut, Luxembourg  
Telephone: +352 768 494 1 • Fax: +352 768 495

### **DYNABRADE DO BRASIL**

Rua Oneda, 632 • Sao Bernardo do Campo • SP - CEP 09895-280  
Telephone 55-11-4390-0133 • Fax 55-11-4399-1067

### **DYNABRADE INDIA ABRASIVE POWER TOOLS Pvt Ltd.**

EL-54, TTC Industrial Area, M.I.D.C. Mahape, Electronic Zone, Navi Mumbai - 400705  
Maharashtra, India • Telephone: +91 22 2763 2226 • Fax: +91 22 2763 2228

**Try Our U.S. Consumer Toll-Free Number**  
**1-888 DYNABRADE (or 1-800-828-7333)**

**DISTRIBUTED BY:**



©DYNABRADE, INC., 2011

PRINTED IN USA

