

Models:

- A10140 - 8" Non-Vacuum**
- A10142 - 8" Basic Vacuum**
- A10144 - 8" Deluxe Vacuum**
- A10146 - 8" Vac-Ready™**
- A10152 - 8" Central Vac-Ready™**

8" Mud Hog

Gear Driven Orbital Sander

Two-Handed Air-Powered 900 RPM

⚠ WARNING

Always operate, inspect and maintain this tool in accordance with the Safety Code for portable air tools (ANSI B186.1) and any other applicable safety codes and regulations. Please refer to Dynabrade's Warning/Safety Operating Instructions for more complete safety information.

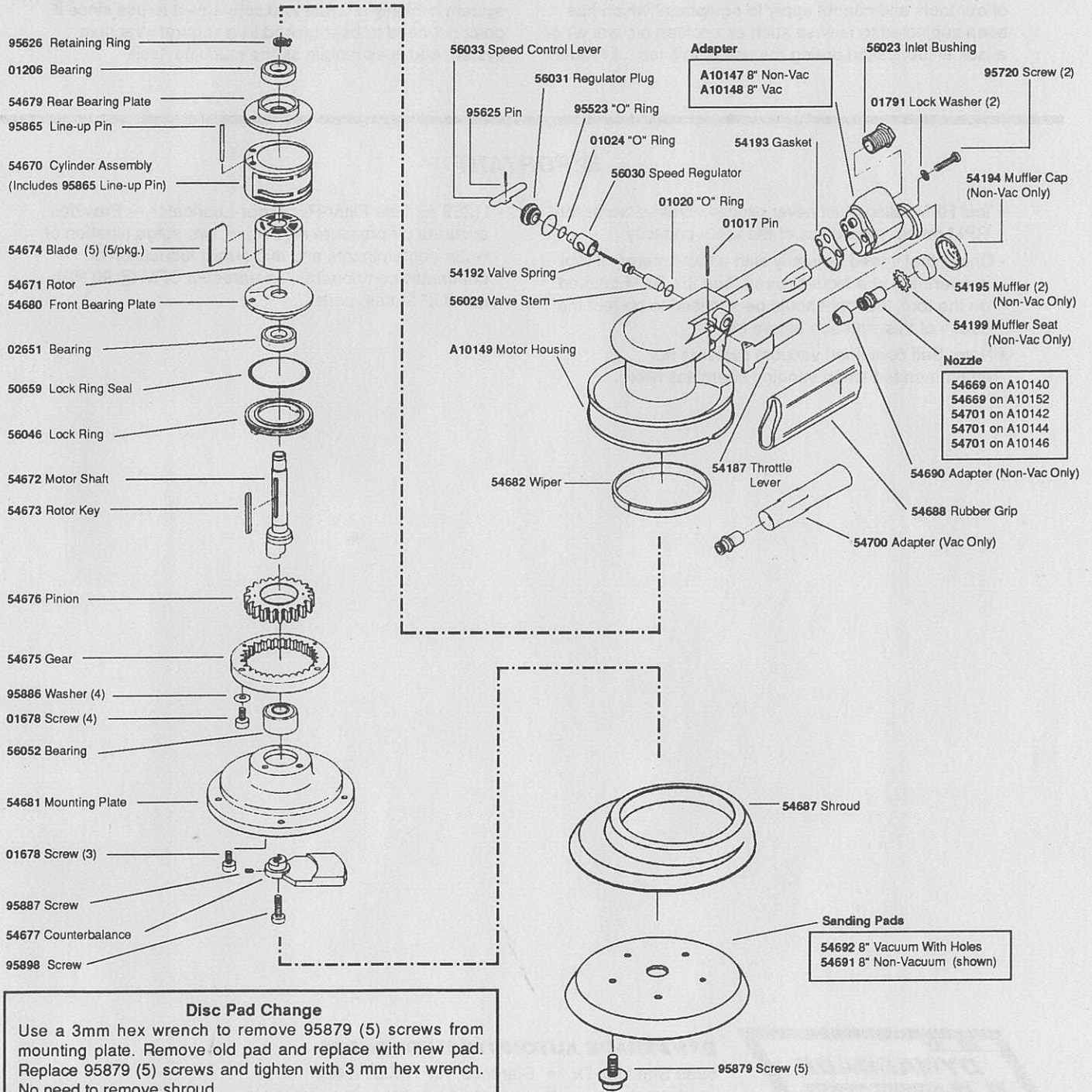

Disc Pad Change

Use a 3mm hex wrench to remove 95879 (5) screws from mounting plate. Remove old pad and replace with new pad. Replace 95879 (5) screws and tighten with 3 mm hex wrench. No need to remove shroud.

Suggested Weight of Pad

8"- Use pad weighing approx. 180 grams

IMPORTANT: ALL DYNABRADE AIR TOOLS MUST BE USED WITH A FILTER-REGULATOR-LUBRICATOR TO MAINTAIN ALL WARRANTIES

All Dynabrade motors use the highest quality parts and metals available and are machined to exacting tolerances. The failure of quality pneumatic motors can most often be traced to an unclean air supply or the lack of lubrication. Air pressure easily forces dirt or water contained in the air supply into motor bearings causing early failure. It often scores the cylinder walls and the rotor blades resulting in limited efficiency and power. Our warranty obligation is contingent upon proper use of our tools and cannot apply to equipment which has been subjected to misuse such as unclean air, wet air or a lack of lubrication during the use of this tool. Frequent

drainage of water traps in air lines is recommended. Each tool on each drop should also be equipped with a secondary air processing unit. This consists of an in-line filter, regulator and lubricator. If the lubricating oil permeating the air in the work area causes danger of contaminating the workpiece, it is suggested that the Dynorbital be hooked up to a central vacuum system or one of our unique vacuum systems that gather all such oil in a paper dust bag. This self contained vacuum system is highly efficient and convenient to use since it does not need to be attached to a separate vacuum system and is as mobile as the machine itself.

IMPORTANT

- Tool RPM rating must never exceed abrasive/accessory RPM rating, regardless of the tool's capacity.
- Check tool speed regularly with a tachometer. If tool is operating at a higher speed than the RPM marked on the tool, the tool should be serviced to correct the cause of this situation before use.
- Note: Self contained vacuum systems not recommended when sanding fiberglass fillers.
- 11289 Air Line Filter-Regulator-Lubricator — Provides accurate air pressure regulation, two-stage filtration of water contaminants and micro-mist lubrication of pneumatic components; operates 28 CFM @ 90 PSI; has 3/8" female ports.



DYNABRADE AUTOMOTIVE PRODUCTS

8989 Sheridan Dr. • Clarence, NY 14031-1490
(716) 631-0100 • Fax: (716) 631-2073 • Telex: 646540
1-800-828-7333 (USA) • 1-800-344-1488 (Canada)